

2 Gear Rock Crawler Portal

FEATURES AND
SPECIFICATIONS

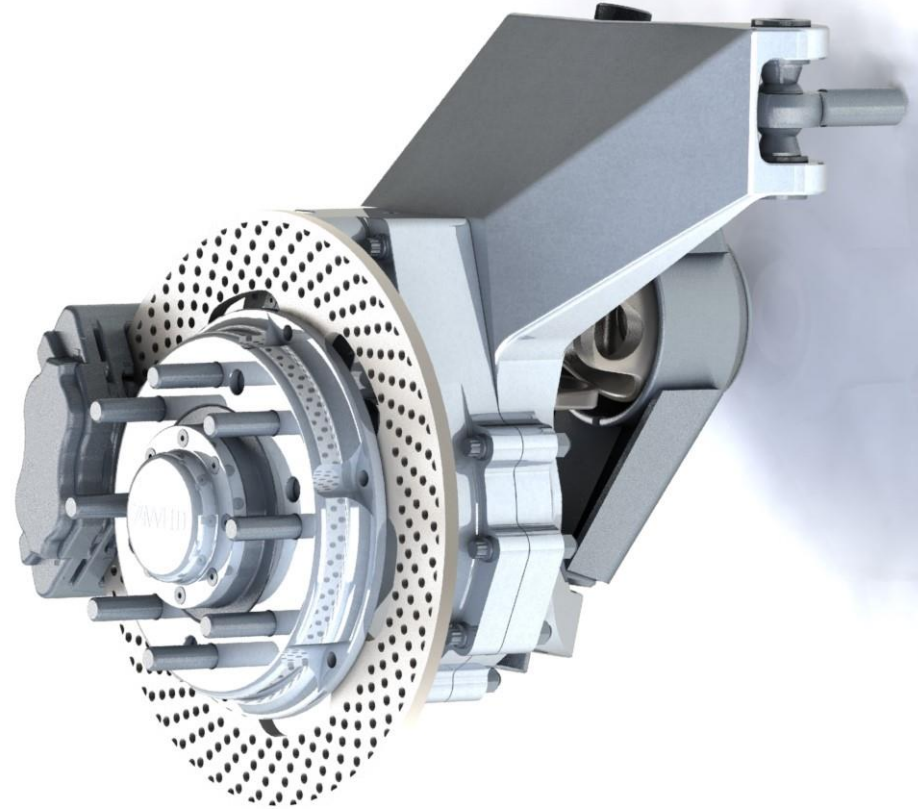

FEATURES AND SPECS

- 1.83 Gear Ratio
- 4.27 Inch Lift
- Optimized Steering Geometry
- Spidertrax Unit Bearing Integration
- Wilwood Brake Package

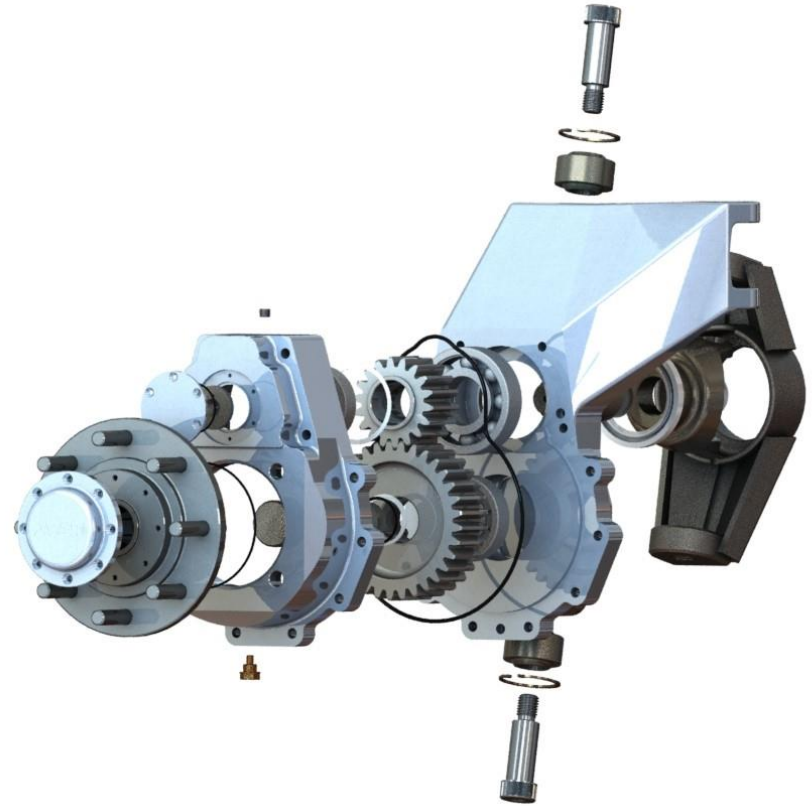

1.83 Gear Ratio

- 83% GEAR REDUCTION AT THE HUB
- LESS STRESS ON DRIVELINE COMPONENTS
- 2 GEAR DESIGN PROVIDES A 4.27 INCH VERTICAL LIFT
- LIFT CREATES 4.27 INCHES OF GROUND CLEARANCE

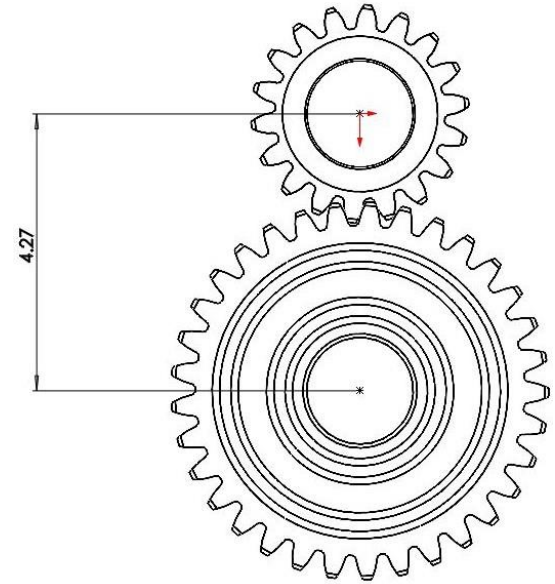
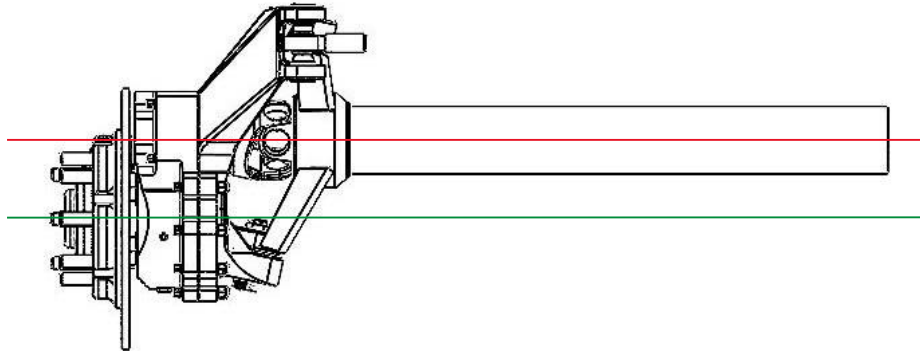

Optimized Steering Geometry

- 12 DEGREE KPI CREATES MORE OPTIMIZED SCRUB FOR TIRES THAT ARE 40 INCHES OR GREATER
- 49 DEGREES OF STEERING WITH INTEGRATED STEERING STOPS

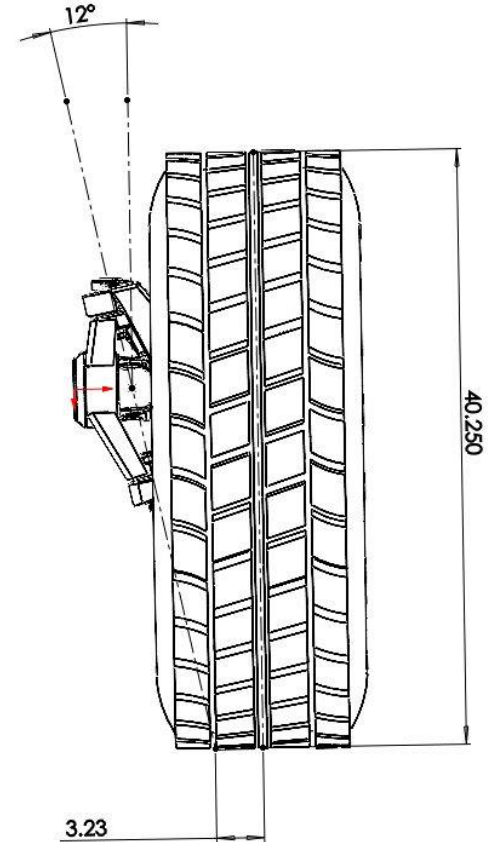

Spidertrax Unit Bearing Integration

- SPIDERTRAX 40 SPLINE ULTIMATE UNIT BEARING INTEGRATION
- 40 SPLINE UPPER AND LOWER GEAR SHAFTS
- UPPER SHAFT MATES TO 35 SPLINE SPIDERTRAX YOKE

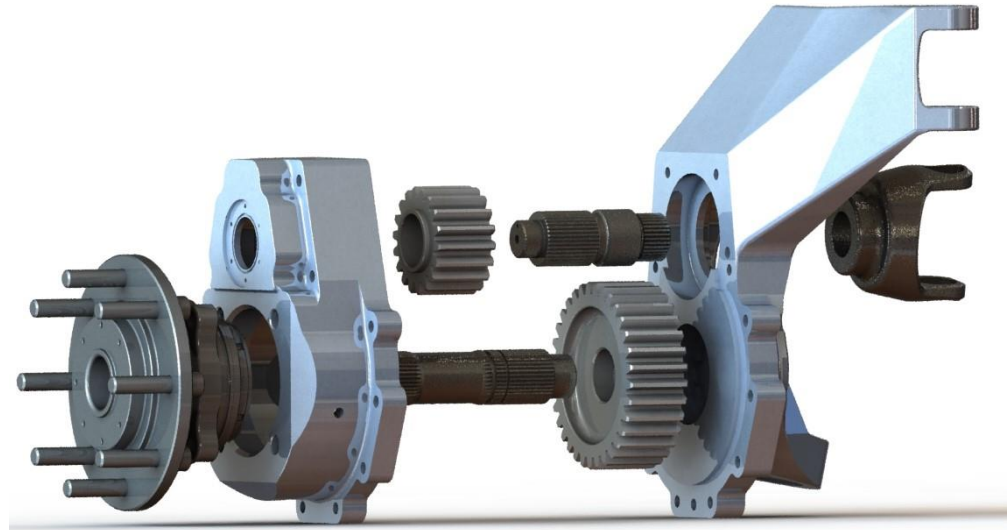

Wilwood Brake Package

- WILWOOD DYNALITE CALIPER MOUNTS INCLUDED
- 14 INCH SPIDERTRAX ROTOR HAT INCLUDED

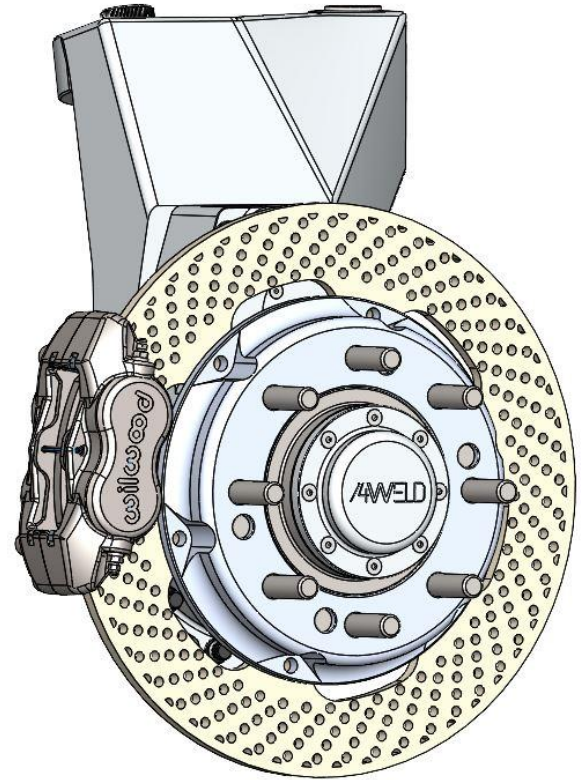

Parts Breakdown

- FULLY MACHINED 7075 ALUMINUM OUTER KNUCKLE
- 6061 ALUMINUM PORTAL BOX
- 8620 HOBBED AND HEAT-TREATED GEARS
- 4340 HEAT TREATED UPPER AND LOWER SHAFTS
- FK ROD ENDS 1 INCH UNIBALLS
- SPIDERTRAX 40 SPLINE ULTIMATE UNIT BEARING
- SKF BEARINGS AND ROTARY SHAFT SEALS